

2013 CESSNA GRAND CARAVAN EX AMPHIBIOUS

N904LS SN: 208B5030



Aircraft Description

This exceptional Cessna Grand Caravan EX, with only 483 Hrs TT, has a one-of-a-kind, custom, executive, interior that is sure to impress and allows for your passengers to travel in quiet luxury! Your clients will appreciate the journey as much as the arrival at your destination. The avionics include the Garmin G1000 Integrated Flight Management System – Glass Cockpit - with new GFC 700 Auto Flight Control System. Additional modifications include, the sleek Wipline 8750 Amphibious Floats, Single Point Refueling System G2, Air Conditioning and Pitch Latches. The wide boarding steps allow for a safe and easy passenger entry, via the Cargo Door. This Aircraft has been professionally flown, and operated, by only one corporate owner since new. All annual inspections were performed by the experts at Wipaire Inc., a Certified Cessna Repair Station and Caravan Service Facility, confirming the most comprehensive inspections were performed. This impressive Aircraft is certainly a must-see!

PRICE	Call For Details
-------	-------------------------

AIRCRAFT	N904LS SN: 208B5030 483 Hrs TT
----------	-----------------------------------

ENGINE	PT6A-140 Pratt & Whitney 483 Hrs TT
--------	--

PROPELLER	Hartzell HC-B3TN-3AF, Three Blade Propeller HC-B3TN-3 AFY 106" 483 Hrs TT
-----------	---

MODIFICATIONS	Wipline 8750 Amphibious Floats Single Point Fueling System G2 Air Conditioning Propeller Pitch Latches Firewall Boiler Plate Reinforcement Wide Boarding Steps – Cargo Door Lake and Air Gear Advisory System Oxygen System 11.5 VAC Cabin Power Outlets - four As Configured: Max Take Off Weight 9062 lbs Useful Load on Amphibs 2386 lbs
---------------	--

**ADDITIONAL
OPTIONS
INCLUDED**

Extended Baggage
Land Plane Landing Gear
LED Lighting
Corrosion Proofing
300 Amp Starter/Generator
Float Plane Provisions
Water Depth Gauge
Exhaust Deflector
Annual 6/2017
Cescom / Camp Maintenance Tracking Program

INTERIOR

The Wipaire custom interior, is impressive and inviting. With seating for six passengers, it includes two forward facing, side-by-side, chairs and a four place club seating layout with retractable writing tables. All passenger seats are fully articulating, able to recline at the press of a button and have a three point seatbelt system. All seating is covered in butter soft, light beige, leather. The crew seats are fitted with cool and comfortable sheepskin inserts. Crew seats are equipped with a five point harness system.

Custom side drink rails and retractable writing tables are constructed in composite material and covered in a light, wood grain, high gloss, veneer. The side drink rails are further complimented with brushed silver plating. This impressive interior also includes two custom pyramid refreshment centers and two aft place Divan seating.

The custom wool carpet is in a complimentary, crème color with stunning burgundy diamond accents. The cargo door, with the wide step modification, allows for safe and easy passenger and baggage loading/unloading.

EXTERIOR

This Aircraft was professionally painted and customized by Wipaire's experienced technicians. Wipaire's expertise and craftsmanship is highlighted from the high end, Matterhorn White topcoat applied overall, to the custom striping created using AcryGlo Burgundy, JetGlo Express Gold and Axalta Black.

This Aircraft shows beautifully and is in excellent condition. The owner took true pride in maintaining this Aircraft. It was rinsed, with deionized water, after each use.

Prices are in U.S. Dollars, FOB St. Paul, Minnesota, U.S.A., and are subject to change without notice. Prices do not include taxes, duties or tariffs. The accuracy of the above specifications are only offered as to the best of our knowledge at the time this document was printed. Aircraft is subject to prior sale and/or removal from the market. Aircraft to be sold "as is, where is." All specifications and representations of the aircraft are subject to verification by the buyer before purchase.





AVIONICS

Garmin G1000 Integrated Flight Management System
GFC 700 Flight Control System
Three Glass 10" displays, Pilot PFD, Center MFD, Co-Pilot PFD
Synthetic Vision
AirCell ST-3100 SATCOM
Jeppesen Chart View
Synthetic Vision Technology by Garmin (SVT)
Traffic Advisory System
GWX-68 Weather Radar
TAWS-B Garmin
GTX-33 Mode S Transponder – Dual
Artex C406-N ELT
Dual Audio Control Panel
KRA 405B Radar Altimeter
XM Satellite Weather/Entertainment
PA System w/Aft Cabin Speakers
Marine Radio
Bose 6 Pin Headset Jacks
Passenger Intercom System
Crew Call
Aux Music Input

AIRCRAFT DESCRIPTION



AIRCRAFT DESCRIPTION



With seating for six passengers, it includes two forward facing, side-by-side, chairs and a four place club seating layout with retractable writing tables.



AIRCRAFT DESCRIPTION



The custom wool carpet is in a complimentary, crème color with stunning burgundy diamond accents.



www.wipaire.com | 1700 Henry Avenue - Fleming Field, South St. Paul, MN 55075

08082017v1



Custom side drink rails and retractable writing tables are constructed in composite material and covered in a light, wood grain, high gloss, veneer





www.wipaire.com | 1700 Henry Avenue - Fleming Field, South St. Paul, MN 55075

08082017v1

AIRCRAFT DESCRIPTION



Matterhorn White topcoat applied overall, to the custom striping created using AcryGlo Burgundy, JetGlo Express Gold and Axalta Black.





www.wipaire.com | 1700 Henry Avenue - Fleming Field, South St. Paul, MN 55075

08082017v1

AIRCRAFT DESCRIPTION





www.wipaire.com | 1700 Henry Avenue - Fleming Field, South St. Paul, MN 55075

08082017v1



WIPLINE 8750 FLOATS

Flying to the remote Canadian Shield or hopping between white sand beaches of the islands, Wipaire can outfit your Grand Caravan series aircraft with the versatility you need. The Caravan is frequently referred to as the sport utility vehicle of the air. Combine this workhorse of an aircraft with a set of rugged Wipline 8750 floats and our performance, convenience or utility enhancing modifications and you have an aircraft that will fly you from business meeting to weekend getaway.

FEATURES AND BENEFITS

- Amphibious or seaplane floats available
- Gross weight of 9,062 pounds on floats, a 255 pound increase over the Grand Caravan EX stock gross weight
- Available for the Grand Caravan EX, Grand Caravan with Blackhawk XP140 Performance Upgrade, and the 675 hp Grand Caravan
- Hull features fluted, high deadrise forward bottoms and extra buoyancy — inspired by our very successful 13000 float for the Twin Otter, which is renowned for its superior handling in high seas and wind
- Low maintenance main gear retraction mechanism and oleo design with no latches or slides to lubricate or stick
- Best nose and main gear on the market, proven in the field and imitated by competitors
- Enhanced safety with amphibious gear advisory system and gear indicator on float deck of amphibious floats
- Non-skid coated, flat top decks for safety
- Four large float hatches for gear with 150 pounds carrying capacity each
- Aluminum skins and parts are laser cut and rivet holes are pre-punched so that replacement parts fit perfectly
- Replaceable wear strips on main keel for ease of maintenance

Wipaire also offers modifications, paint refinishing, interiors, avionics and maintenance. Purchase your floats and modifications from the only company with over 55 years of continuous float production and be assured we'll be there when you need support.

SPECIFICATIONS FOR WIPLINE 8750 FLOATS

WEIGHT

Amphibian System Total Weight	1,678 lbs (761 kg)
Amphibian Exchange Weight	1,142 lbs (518 kg) ¹
Seaplane System Total Weight	1,294 lbs (587 kg)
Seaplane Exchange Weight	757 lbs (343 kg) ¹
Max Aircraft Gross Weight	9,062 lbs (4,110 kg)

DISPLACEMENT IN FRESH WATER

Amphibious Floats	8,240 lbs (3,738 kg)
Seaplane Floats	8,741 lbs (3,965 kg)

MAXIMUM FLOTATION

Amphibious Floats	9,155 lbs (4,153 kg) ²
Seaplane Floats	9,712 lbs (4,405 kg) ²

1) Exchange weight is equal to the float installation weight minus aircraft landing gear weight.

2) Per FAR 23.751 with 80% reserve buoyancy (2 floats)

FLOAT DIMENSIONS

Length – Seaplane	31' 2" (9.50 m)
Length – Amphibian	31' 9" (9.68 m)
Height – Hull	3' 3" (0.99 m)
Width – Hull	3' 6" (1.07 m)
Float Locker Capacity (each)	150 lbs (68 kg)

CARAVAN PERFORMANCE ON AMPHIBIOUS FLOATS

Engine (for Grand Caravan EX)	PT6A-140A (867 HP)
Take off run (land)	1,826 ft (556 m)
Take off over 50 ft obstacle (land)	2,425 ft (739 m)
Take off run (water)	2,000 ft (610 m)
Take off over 50 ft obstacle (water)	3,270 ft (997 m)
Rate of climb (per/min)	1,212 ft (369 m)

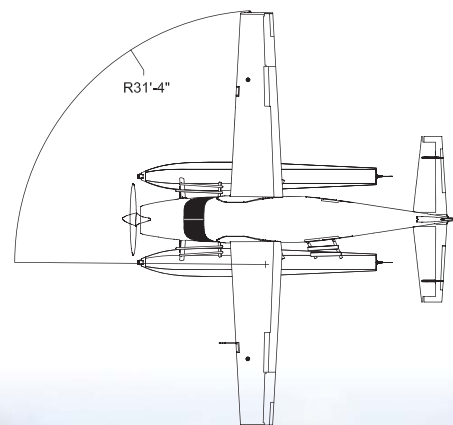
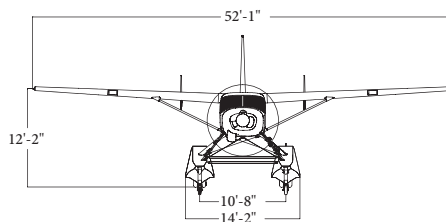
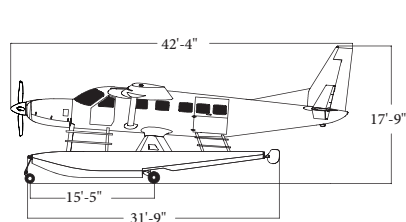

CONTACT Us

FOR MORE INFORMATION CONTACT

Dale Fehrenbach
Turbine Aircraft Sales Manager
Direct: 651.306.0360
dfehrenbach@wipaire.com

Diane Wille
Aircraft Sales & Acquisitions Coordinator
Direct: 651.209.7190
dwille@wipaire.com

