



WIPLINE FLOATS • SKIS • MODIFICATIONS • AIRCRAFT SALES
AVIONICS • INTERIOR • MAINTENANCE • PAINT REFINISHING

SERVICE LETTER 128

Main Landing Gear (MLG) Gravel Deflector Installation

Aircraft Makes/Model(s):	Float Model(s):	Compliance: Optional	By: MAS
Quest Kodiak 100, Textron Aviation 208	7000A, 8750A	Part Number: 1005612	Approved: DRH
		Date: 11/3/2022	Revision: D

LOG OF REVISIONS

Revision	Description	Date
A	Initial release	11/11/2011
B	Updated hardware call out.	3/14/2012
C	Integrated Service Kit 83 into service letter and added 8750 eligibility.	5/7/2013
D	Full rewrite and format update to address gear equipped with oil bath system.	11/3/2022

FAA approval has been obtained for technical data in this publication that affects STC or TSO design compliance.

EFFECTIVITY:

This service letter applies to all Wipline model 7000 amphibian floats, as installed on Quest Kodiak 100 aircraft per STC SA02848CH, and all Wipline Model 8750 amphibian floats, as installed on Textron Aviation 208 Caravan per STC SA1311GL.

COMPLIANCE:

Service letter compliance is optional and recommended for aircraft operating on gravel runways.

BACKGROUND:

Aircraft operated on gravel runways may experience rock impact damage to the MLG main beam, forward surface and brake bleeder fittings. This service letter and associated kit reinforces the forward surface of the MLG main beam by adding a layer of stainless steel skin, which is attached with fasteners and sealant.

COMPLIANCE METHOD:

Install the parts included in this service letter in accordance with the instructions in the Technical Data section of this service letter.

APPROXIMATE SHOP HOURS:

This service letter will take approximately 1 labor hours for complete.

WARRANTY INFORMATION:

This service letter does not include warranty for labor and parts.

TECHNICAL DATA:

Copies of this service letter, associated service kit, float service manual, modification drawing, and float parts manual are available on the website www.wipaire.com.

1700 Henry Ave - Fleming Field (KSGS), South St. Paul, MN 55075

Phone: 651.451.1205 | Fax: 651.457.7858

www.wipaire.com

ITEMS PROVIDED IN SERVICE KITS**1005612-01 = GREASED MAIN GEAR (whole aircraft requires two kits)****1005612-02 = OIL BATH MAIN GEAR (whole aircraft requires two kits)**

ITEM	KIT -01 QTY	KIT -02 QTY	PART NUMBER	DESCRIPTION
1	3	3	NAS1149F0432P	WASHER
2	1	1	PR-1422-B-2	SEALER COMPOUND*
3	1	1	1005443	GRAVEL DEFLECTOR
4	2	2	MS21044N4	NUTS
5	0	2	750-0030-1/4	THREADSEAL WASHER

*Sealer compound above is provided but may be optionally replaced with Pro-Seal P/N 890-B2 or -B4 or Sikaflex P/N 201 or 252, or equivalent.

Work Instructions

NOTE: This modification may be performed with or without the main landing gear installed into the float hull. If performed "in hull," first position and prepare the aircraft for safe maintenance.

Refer to Figure 1 throughout the following instructions.

1. Remove (1) AN4-5A bolt and (1) NAS1149F0463P washer near top of 1004471 drag link as shown.
2. Remove (2) MS21044N4 nuts and (2) NAS1149F0463 washers from bottom end of drag link.
3. **OIL BATH SYSTEMS ONLY (-02 KIT):** Remove (2) 750-0030-1/4 threadseal washers and replace them with new, provided in kit.
4. Liberally apply the provided sealant, or equivalent, to the entire mating surface between 1005443 gravel deflector and 1004471 drag link. Ensure complete coverage to avoid any voids or pockets. Do not allow excess to drip elsewhere on the landing gear.
5. Fasten 1005443 gravel deflector as follows:
 - a. Replace the (3) removed washers with (3) NAS1149F0432P washers
 - b. Re-install (1) AN4-5A bolt and install (2) new MS21044N4 nuts.
6. Add/blend fillet of sealant around edge of 1005443 gravel deflector.

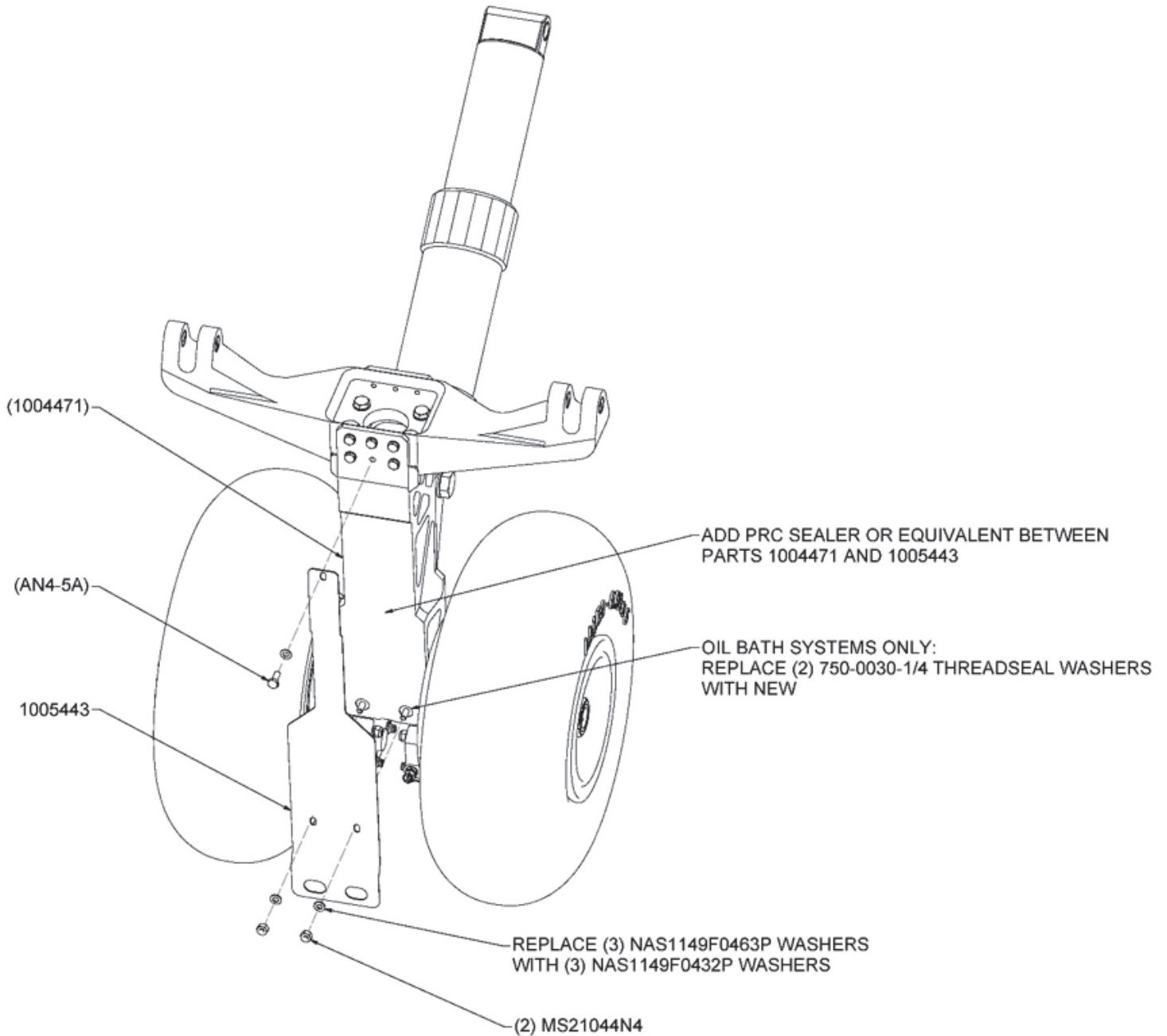

Figure 1

Aircraft Closing & Return to Service

1. Upon completion of inspection, enter information in Aircraft Logbook for completion of Wipaire Service Letter 128.