



WIPLINE FLOATS • SKIS • MODIFICATIONS • AIRCRAFT SALES
AVIONICS • INTERIOR • MAINTENANCE • PAINT REFINISHING

SERVICE LETTER 235

Retention of Fire Boss Hopper Fill Valves

Aircraft Makes/Model(s):	Float Model(s):	Compliance: Optional	By: MAB
Air Tractor AT-802 & AT-802A	10000A	Part Number: 1011930	Approved: SDW
		Date: 7/13/2021	Revision: A

LOG OF REVISIONS

Revision	Description	Date
A	Initial release	7/13/2021

FAA approval has been obtained for technical data in this publication that affects STC or TSO design compliance.

EFFECTIVITY:

This service letter applies to Air Tractor models AT-802 and AT-802A with Wipline 10000 Amphibian Floats installed per STC SA01795CH prior to 2/21/2019.

Note: Installation of the fill system using Wipaire drawing 7D1-4259, revision F, dated 2/21/2019 already incorporates the intent of this service letter.

COMPLIANCE:

Optional compliance

BACKGROUND:

Due to the high flow rate in the fill system, it is possible for the fill valves to become dislodged from the fill tubes. This service letter provides instructions for adding studs and safety wire to the valves and tubes.

COMPLIANCE METHOD:

Modify both fill valves/tubes as shown in the Work Instruction section of this service letter.

APPROXIMATE SHOP HOURS:

The work instruction for this service letter will take approximately 3 labor hours.

WARRANTY INFORMATION:

This service letter does not include warranty for labor and parts.

TECHNICAL DATA:

Copies of this service letter, associated service kit (if applicable), float service manual, and float parts manual are available at www.wipaire.com.

1700 Henry Ave - Fleming Field (KSGS), South St. Paul, MN 55075

Phone: 651.451.1205 | Fax: 651.457.7858

www.wipaire.com

Work Instructions

1. Gain access to the two fill valves located within the hopper. See figure 1. If opening the fire gate, disarm the system while performing maintenance.
2. Loosen clamps and remove both valves.
3. Add (2) #10 holes to each valve and to each fill tube, one on top and one on bottom as they sit in the aircraft. The result is (8) total holes for the whole aircraft. Place these holes 3" from the edge of the valve/tube.
4. Create studs at these locations using the hardware identified in Figure 1 and Table 1. Seal with Pro-Seal as needed.
5. Reinstall valves and tighten clamps.
6. Attach 0.041" safety wire between the newly created studs in accordance with AC 43.13 (4 total locations). See Figure 1.
7. Reinstall aircraft panels and close fire gate as needed.

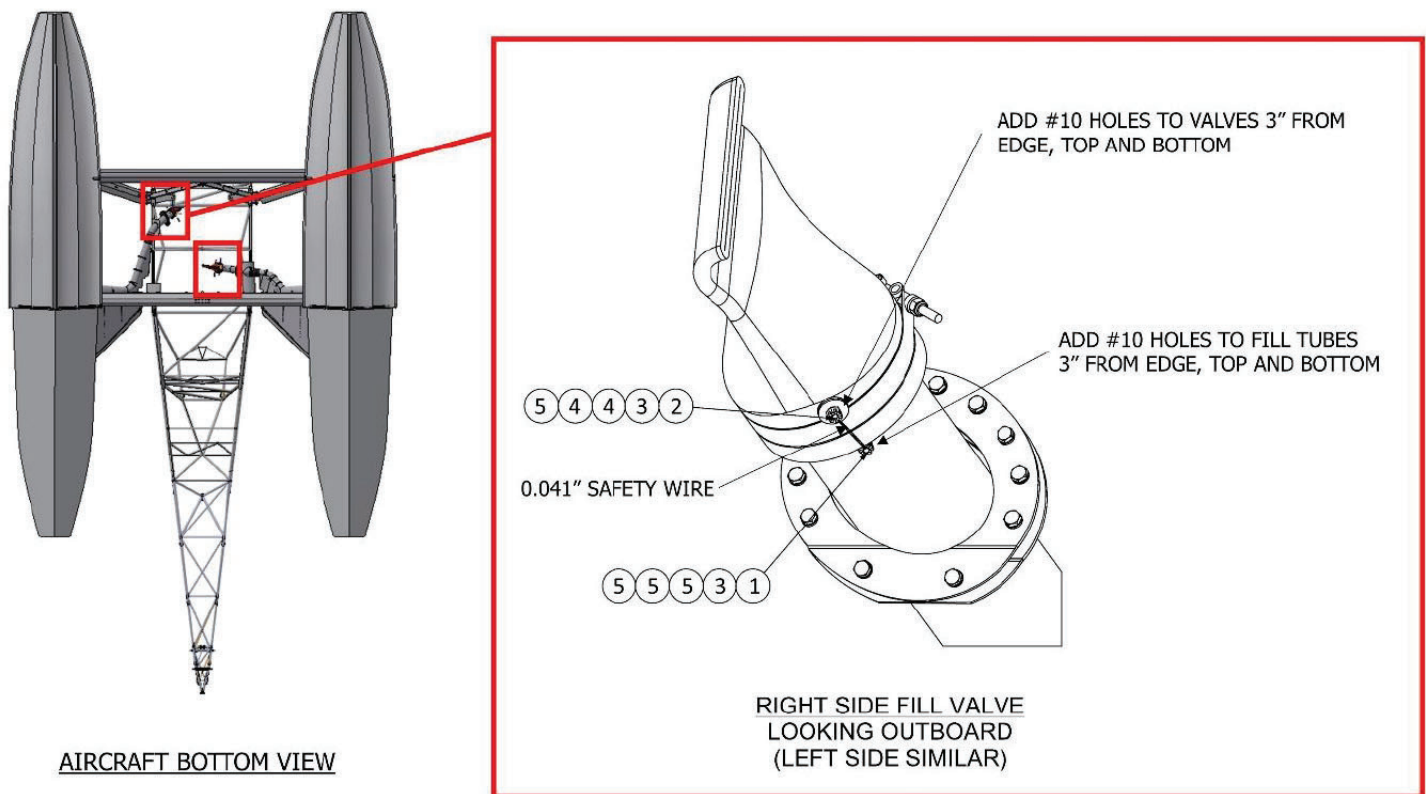

Figure 1

ITEM	PART NUMBER	DESCRIPTION
1	AN3C4	BOLT, 10-32, 0.125 GRIP, DRILLED SHANK, SST
2	AN3C7	BOLT, 10-32, 0.5 GRIP, DRILLED SHANK, SST
3	AN310C3	NUT, PLAIN, CASTELLATED, SST, 10-32
4	AN970C3	WASHER, 0.875 OD, 0.203 ID, 0.063 THK, SST
5	NAS1149C0363R	WASHER, 0.203 ID, 0.063 THK, SST

Table 1



Aircraft Closing & Return to Service

1. Upon completion of inspection, enter information in Aircraft Logbook for completion of Wipaire Service Letter 235.