



WIPLINE FLOATS | MODIFICATIONS | AIRCRAFT SALES  
 AVIONICS | INTERIORS | MAINTENANCE | PAINT

## SERVICE LETTER 276

### Brake Torque Plate Safety Wire

|   |   |                             |                      |
|---|---|-----------------------------|----------------------|
| <b>Aircraft Makes/Model(s):</b>   | <b>Float Model(s):</b>                        | <b>Compliance:</b> Optional | <b>By:</b> MAS       |
| DeHavilland DHC-2, DHC-3,<br>DHC-6<br><br>Pilatus PC-6<br><br>Textron Aviation 208, 208B<br><br>Air Tractor AT-802, AT-802A | 6000A, 6100A, 8000A,<br>8750A, 10000A, 13000A | <b>Part Number:</b> 1013053 | <b>Approved:</b> DRH |
|   |   | <b>Date:</b> 2/11/2026      | <b>Revision:</b> A   |

#### LOG OF REVISIONS

| Revision | Description     | Date      |
|----------|-----------------|-----------|
| A        | Initial release | 2/11/2026 |

FAA approval has been obtained for technical data in this publication that affects STC or TSO design compliance.

#### EFFECTIVITY:

This service letter applies to multiple aircraft models equipped with 6000, 6100, 8000, 8750, 10000, or 13000 amphibian floats. Drilled-head hardware and safety wire is to become standard production on 10000A and 13000A floats in 2026.

#### COMPLIANCE:

Compliance is optional.

#### BACKGROUND:

Wipaire has received multiple reports of brake torque plate fasteners loosening, despite the presence of threadlocker.

#### COMPLIANCE METHOD:

As desired or if service history suggests a recurring issue despite proper wheel and brake maintenance (heat and vibration), install new hardware with drilled heads and secure with safety wire in accordance with the Work Instructions in this service letter.

#### APPROXIMATE SHOP HOURS:

Replacing and safetying torque plate hardware will take approximately 5 labor hours per aircraft.

#### WARRANTY INFORMATION:

This service letter does not include warranty for labor or parts.

#### TECHNICAL DATA:

Copies of this service letter, associated service kit (if applicable), float service manual, and float parts manual are available at [www.wipaire.com](http://www.wipaire.com).

| CONFIGURATION TABLE |                                    |
|---------------------|------------------------------------|
| KIT NO              | DESCRIPTION                        |
| -01                 | 6000A/6100A, 8000A FLOATS          |
| -02                 | 8750A FLOATS (OIL BATH OR GREASED) |
| -03                 | 10000 AND 13000A FLOATS            |

| ORDER INDIVIDUALLY AS NEEDED                          |     |     |     |               |  |
|---|-----|-----|-----|---------------|--|
| PARTS LIST BY CONFIGURATION (FULL AIRCRAFT QTY SHOWN) |     |     |     |               |  |
| ITEM  | -01 | -02 | -03 | PART NUMBER   | DESCRIPTION                                  |
| 1   | 8   | 12  | 0   | NAS1352-5H10P | SCREW, SOCKET HEAD, DRILLED, 5/16-18 X 0.625 |
| 2   | 8   | 12  | 0   | NAS1352-6H10P | SCREW, SOCKET HEAD, DRILLED, 3/8-16 X 0.625  |
| 3   | 0   | 0   | 24  | MS24677-66    | SCREW, SOCKET HEAD, DRILLED, 3/8-16 X 1      |
| 4   | 1   | 1   | 1   | MS20995C32    | SAFETY WIRE, 0.032", 30FT ROLL               |

| ALTERNATE HARDWARE LIST - REFERENCE                   |     |     |     |               |  |
|---|-----|-----|-----|---------------|--|
| PARTS LIST BY CONFIGURATION (FULL AIRCRAFT QTY SHOWN) |     |     |     |               |  |
| ITEM  | -01 | -02 | -03 | PART NUMBER   | DESCRIPTION                                  |
| 1   | 8   | 12  | 0   | MS24677-48    | SCREW, SOCKET HEAD, DRILLED, 5/16-18 X 0.625 |
| 2   | 8   | 12  | 0   | MS24677-63    | SCREW, SOCKET HEAD, DRILLED, 3/8-16 X 0.625  |
| 3   | 0   | 0   | 24  | NAS1352-6H16P | SCREW, SOCKET HEAD, DRILLED, 3/8-16 X 1      |

## Work Instructions

1. Position and prepare aircraft for safe maintenance.
2. Jack or hoist aircraft so that main landing gear wheels can be removed. Refer to associated float Service Manual.
3. Remove brake components and main landing gear wheels to access brake torque plate.
4. Remove and replace torque plate hardware as shown in Figure 1. Threadlocker is recommended (Loctite 242 or equivalent). Torque to:

5/16 screws: 150 in-lbs

3/8 screws: 190 in-lbs

**Note:** See **ALTERNATE HARDWARE LIST** above for additional procurement options

5. Safety wire with MS20995C32 in accordance with AC43.13-1B. Single-wire method is recommended for six-bolt patterns to ensure clearance with axle. Refer to Figure 2.
6. Reinstall brake and wheel components.

6000A/6100A, 8000A  
(IMAGE IS REPRESENTATIONAL)

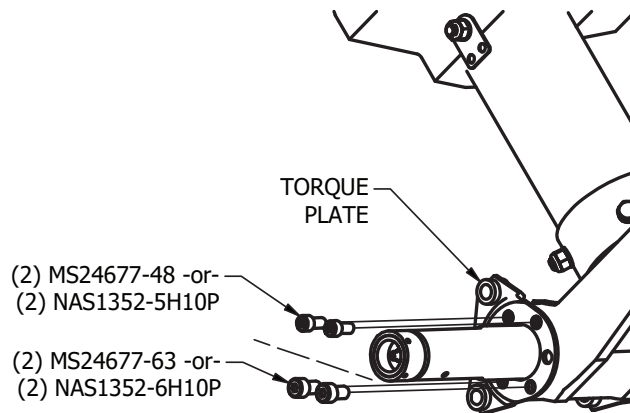

8750A

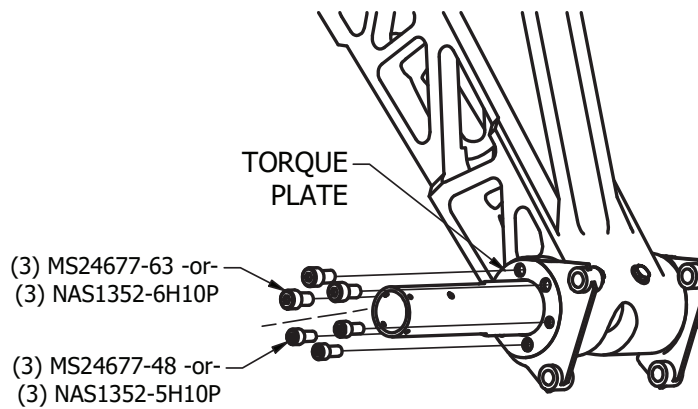

10000, 13000A

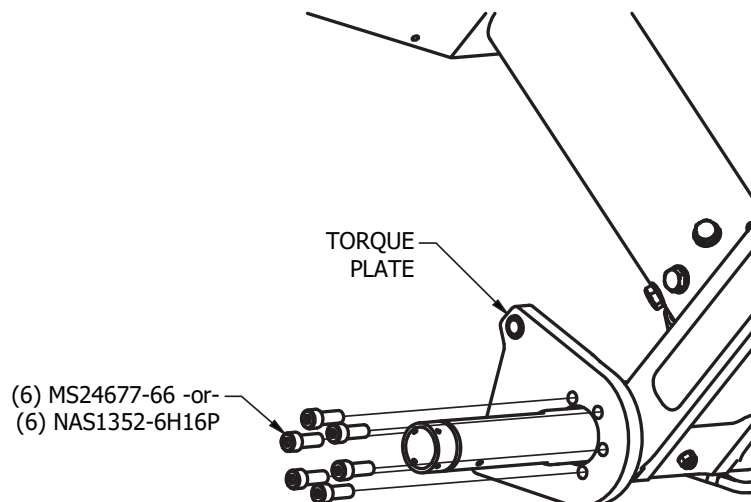

**Figure 1 – Hardware for Safety Wire (Qtys shown are per Torque Plate)**

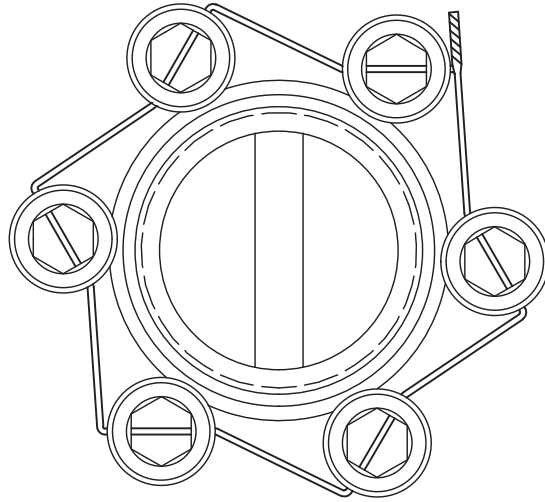

**Figure 2 – Single-Wire Method, Six-Bolt Pattern**

## **Aircraft Closing & Return to Service**

1. Upon completion of inspection, enter information in Aircraft Logbook for completion of Wipaire Service Letter 276.